



mounting
systems



Alpha⁺

The Alpha⁺ system is a robust mounting system designed and optimized for exceptionally fast, easy installation of PV modules on pitched roofs. Mounting Systems' new, ultra-fast Clickstone technology, extensive component pre-assembly and unique assembly features simplify planning, speed installation and enhance system safety and reliability.

Unlimited flexibility

With the Alpha⁺, modules can be easily mounted on a wide range of pitched roof surfaces.¹

Significant savings

Alpha⁺ has been specifically designed to minimize installation times. A high degree of pre-assembly, intelligent design of the new Clickstone connections, improved and optimized rail design and the use of a single tool on the roof all result in a sizeable reduction in installation time and cost.

Precision accuracy without cutting

The use of telescoping rails rail ends allows precision rail lengths with no cutting or sawing of metal – in the shop or on the roof.

Vertical adjustability

The Alpha⁺'s improved design provides enhanced vertical adjustability to make leveling the PV array even easier.

Structural reliability

Using Mounting Systems' Alpha⁺ Quick Configurator software, the Bill of Materials (BOM) for any specific configuration can be calculated in minutes along with a PE-stamped, project-specific structural analysis and verification to the appropriate building codes and national standards.

Maximum service life

All components are made of extruded aluminum and stainless steel. This guarantees both full recyclability and maximum service life due to high resistance to corrosion.



On-roof



Framed module



Orientation portrait



Orientation landscape



Double Roman Tiles



Slate



Plain Tiles



Corrugated metal



Bitumen shingles



¹ Alpha⁺ is compatible with nearly every type of roof. For detailed information, please contact us during the planning phase.



mounting
systems

Application	<i>Pitched roof</i>
Roof types	<i>Suitable for most types of roof cladding</i>
Roof slope	<i>Up to 60° ¹</i>
Building height	<i>Up to 66 ft • 20 m ¹</i>
PV modules	<i>Framed</i>
Module orientation	<i>Landscape, portrait</i>
Size of module array	<i>not limited ²</i>
Height allowance	<i>Up to 1.5 in • 38 mm</i>
Rail span	<i>Up to 6.6 ft • 2 m ¹</i>
Standards	<i>International Building Code IBC 2009 California Building Code CBC 2010 ASCE/SEI 7-10 Aluminum Design Manual 2010 ANSI/AISC 360-05 ACI 318-08</i>
Supporting profiles	<i>Extruded Aluminum (EN AW 6063 T66)</i>
Hooks, small parts	<i>Stainless steel (V2A)</i>
Color	<i>Mill finish or black anodized</i>
Warranty	<i>10 years</i>

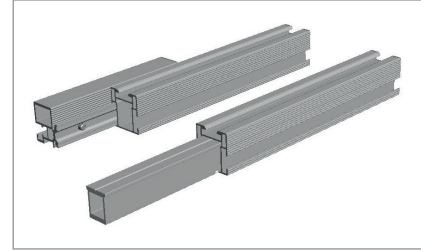

Splice options

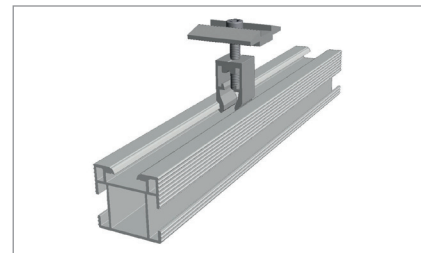

Module clamp with Clickstone



Telescoping end piece

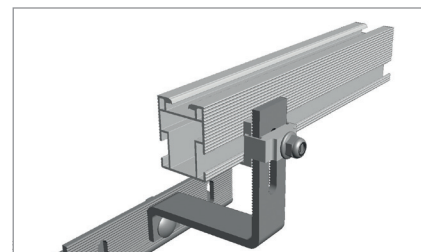

Roof hook with QuickAttach rail connection

Alpha+TD-USA1307

- 1 Different maximum values may apply, and are dependent on site, building, choice of roof attachments and modules. Using the Alpha+ calculation tool the correct values for each project calculated quickly and easily.
- 2 Due to thermal expansion of the material, Mounting Systems recommends a slight gap in the array every 12 m (39.4 ft.)

For further information: www.mounting-systems.com
Subject to change without notice
2013 © Mounting Systems, Inc.